

P20LDL – Plaster-in 20 Linear Downlight

Installation Instructions

Page 1

- **Please read entire instruction before beginning installation.**
- Keep all instructions for future reference.
- Any modification of the luminaire voids any and all written or implied warranty.
- Manufacturer accepts no responsibility for damage to persons or property arising through installation or use.



- Risk of Fire/Electric Shock. Disconnect power at fuse or circuit breaker before installing. Failure to do so may result in personal serious injury.



- Risk of Fire/Electric Shock. Fixture must be installed in accordance with local and/or National Electrical Code.



- Installation and maintenance should only be performed by a qualified electrician.

Unpacking Instructions

Before you begin, please un-pack, identify and inspect all components. Per the TERMS AND CONDITIONS OF SALE, please contact Inter-lux if any items are found to be damaged or missing.

Fixtures will be packaged in multi-pack boxes or individually for smaller quantities. Individual fixtures are identified similar to:

Fixture

P20LDL-S-59950-L-835-OD-C4

Description

P20LDL Housing Assembly, Straight, 59.950" L, Low Power, 80 CRI, 3500K, Opal Diffuser, 4ft Plenum Rated Feed Cord

In addition to box labels, each fixture will be individually labeled on the back as shown:

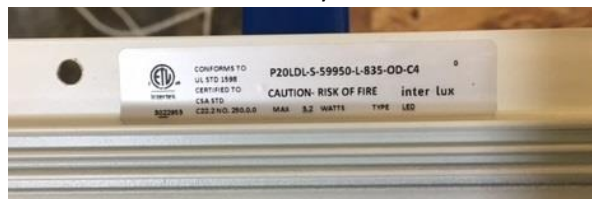

The following page shows all possible parts for the P20LDL. Not all items are needed for every installation. Refer to your specific packing list to identify parts.

Once all items are identified and sorted, proceed to installation steps.

Technical Support Line (410) 381-1497

P20LDL – Plaster-in 20 Linear Downlight

Installation Instructions

Page 2

Parts Identification (not to scale)

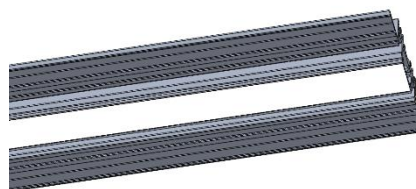

P20 Linear Light

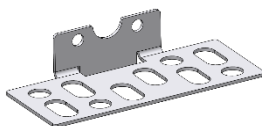

P20 End Cap

730-20116-300



Square Joiner

820-10039-300

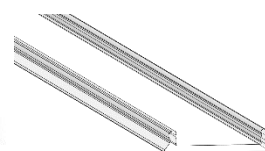

Opal Diffuser 710-10012-400

Satin Diffuser 710-10041-400

Installation Instructions

Locate and review any construction plans and the Inter-lux Record Drawings for all fixture runs.

NOTE: It is recommended to locate and lay out all components for each fixture “run”. A fixture run typically consists of endcaps, joiners, lengths of housings, lengths of P20LDL lights and driver boxes.

Housing and light fixture lengths may be similar in appearance but slightly different in length. Driver boxes may be similar in appearance but contain different power supplies. Be sure to identify all the correct lengths and drivers for each fixture run.

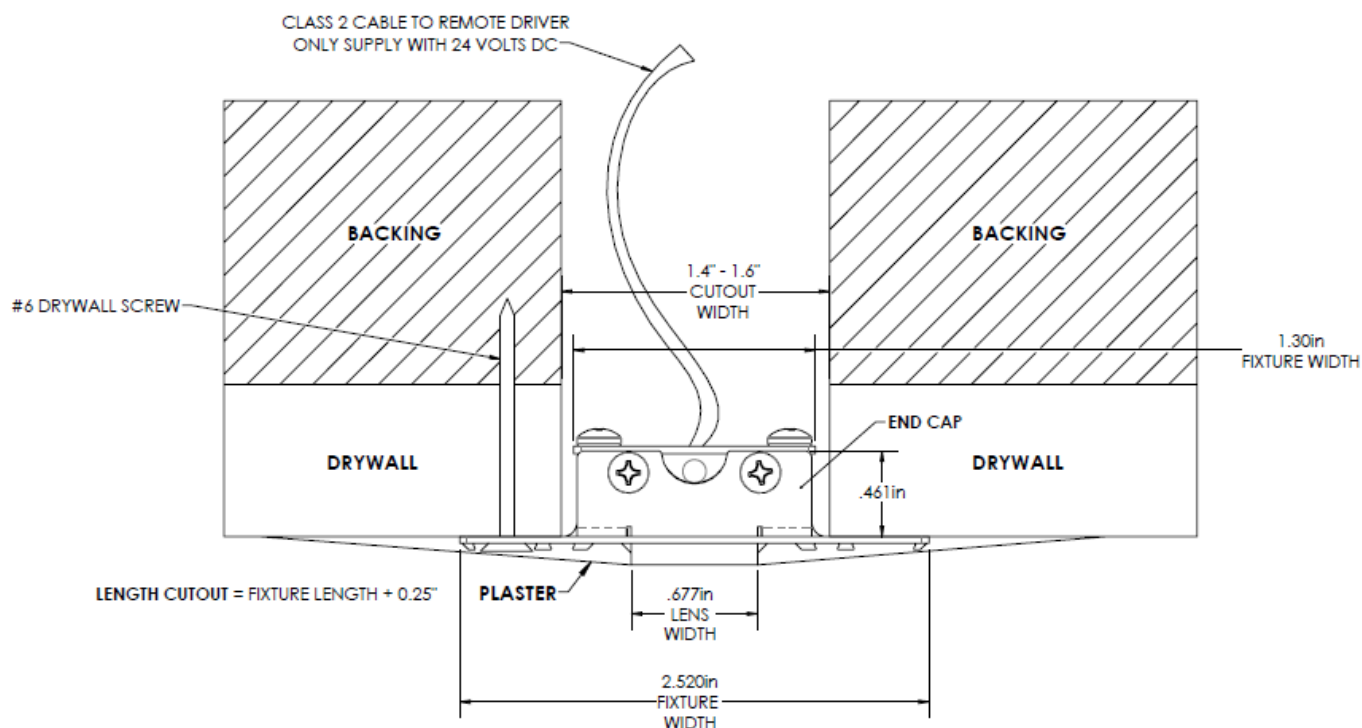

P20LDL – Plaster-in 20 Linear Downlight

Installation Instructions

Page 3

Install Driver Box



The driver box must be mounted and wired in accordance with the National Electric Code (NEC) as well as applicable State and Local codes and jurisdictions.



WARNING: DO NOT HOT-PLUG. Power must be off until all connections are made. LED damage will occur if drivers are powered/energized while making connections.

1. Mount the driver boxes per the construction plans. Typically, this must be in an accessible location.
2. Wire the high voltage power feeds.
3. Wire the dimming or control leads if applicable.
4. The output leads will be connected later, after fixtures are installed.

Plasterboard – Standalone Luminaire

NOTE: Minimum ceiling or wall thickness of 0.5in (12.7mm).

1. Cut Out:

Mark and cut gypsum/plaster board/drywall for desired location of the housing.

Cut Out Length = Fixture Length + 0.25in

Cutout Width = 1.5in +/- 0.1in

2. Mounting Preparations:

The housing must be mounted securely to avoid cracking in the plaster and painted finish. It is recommended that backing (typically wood, supplied by others) be installed behind the perimeter of the fixture and the fixture be secured to the backing. In lieu of backing, the housing can be securely mounted to wall studs and/or anchors as needed (supplied by others).

The housing is supplied without mounting holes and will need to be drilled to align with wood backing, studs or anchors as needed. Use #6 drywall screws (supplied by others). In case of pre-drilling the holes, a ¼" hole size is recommended. Mark and drill mounting holes, in the housing, in desired locations. Recommend a maximum of 24" centers.

The housing is supplied with a sacrificial diffuser which protects the LED sources. This should be left on throughout installation. A final diffuser is supplied to replace the sacrificial after installation.

P20LDL – Plaster-in 20 Linear Downlight

Installation Instructions

Page 4

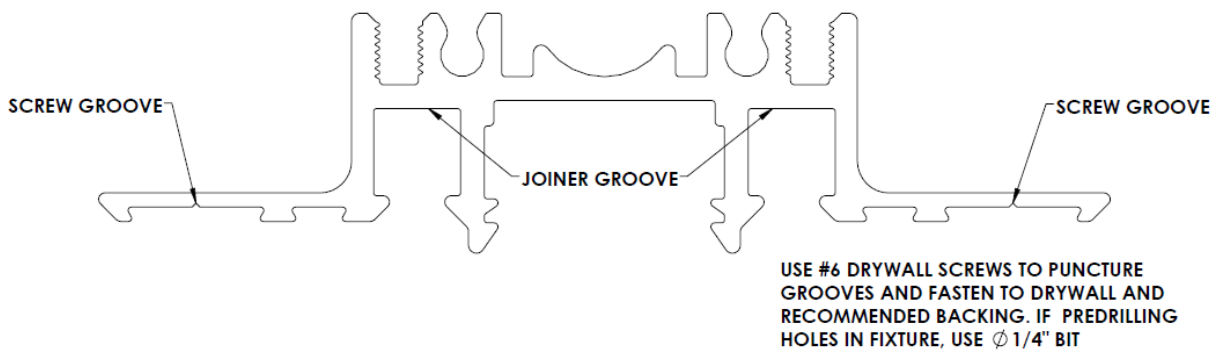

3. Mounting:

Step 1: Feed wire into ceiling cutout then install P20LDL luminaire into ceiling cutout using #6 drywall screws (supplied by others). Leave sacrificial diffuser at all times during installation.

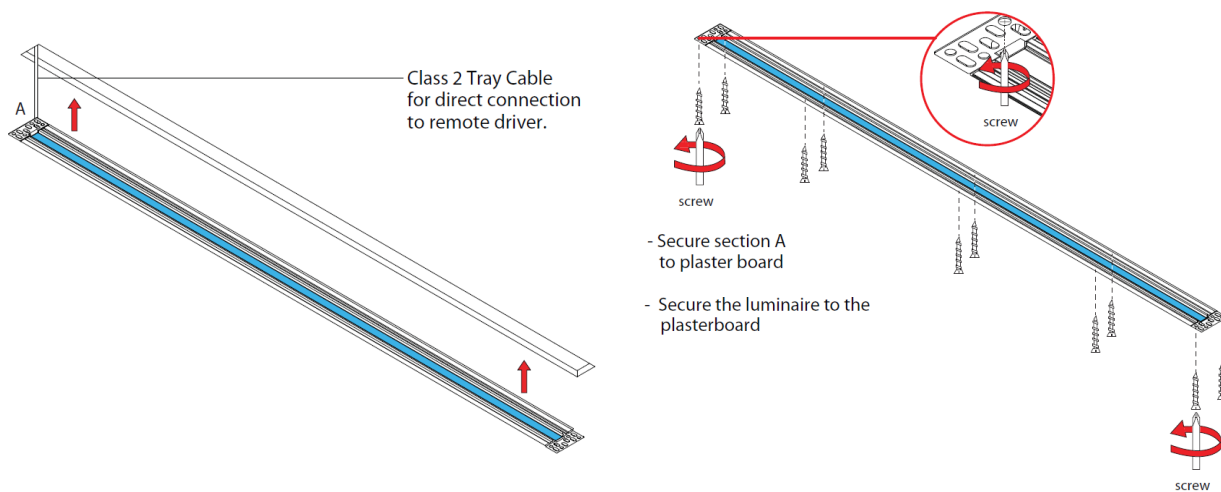

P20LDL – Plaster-in 20 Linear Downlight

Installation Instructions

Page 5

Step 2: Apply plaster so it's even with lens of P20LDL luminaire.

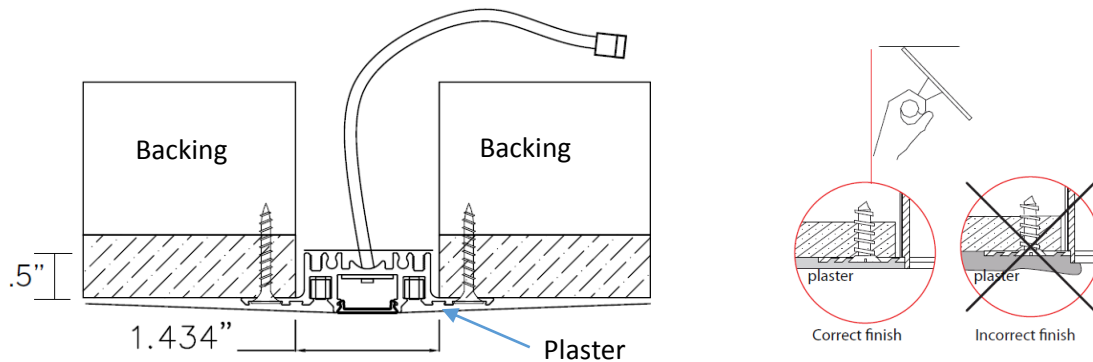

Step 3: Replace sacrificial diffuser with clean finished diffuser until after plaster and paint is fully dry.

Step 4: Energize and test for proper operation.

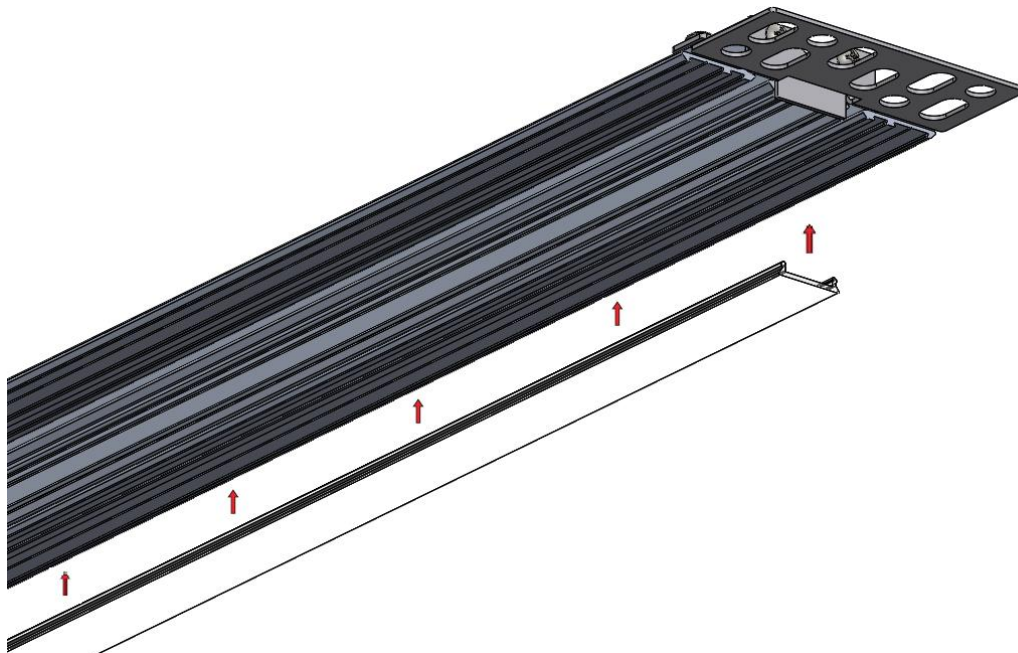

P20LDL – Plaster-in 20 Linear Downlight

Installation Instructions

Page 6

Plasterboard – Continuous Luminaire

NOTE: Minimum ceiling or wall thickness of 0.5in (12.7mm).

Follow Preparation 1 & 2 of Standalone Luminaire.

3. Mounting

Step 1: Install end caps. Starting with first housing, install an endcap, using #4 machine screws provided with Endcap Kit. Repeat the same for the last housing section of the run.

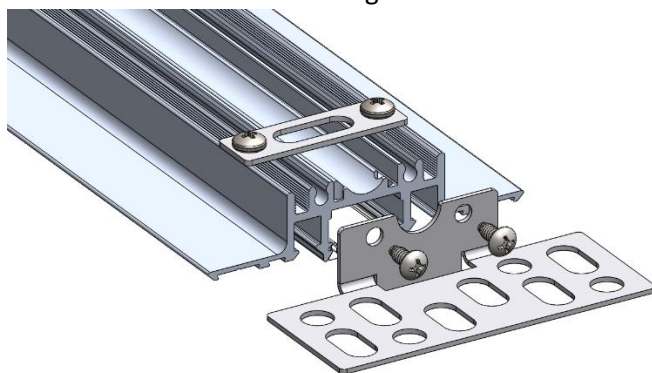

Step 2: Begin with installing the first housing (section A) into the plaster board, using #6 drywall screw (supplied by others).

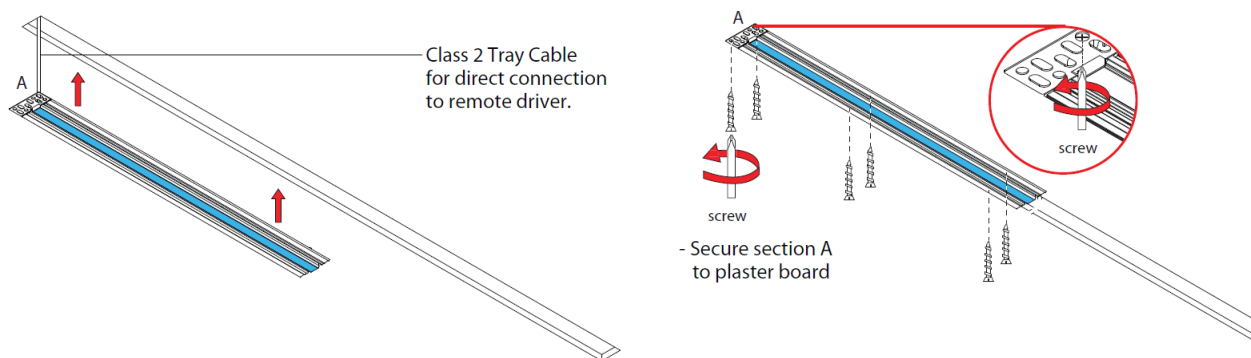

Step 3: Install 2X square joiners into groove of the exposed end of P20LDL housing section A. Before placing P20 section B against already installed section.

Step 4: Install section B into plaster board, using #6 drywall screws (supplied by others)

P20LDL – Plaster-in 20 Linear Downlight

Installation Instructions

Page 7

Step 5: After placing luminaires next to each other, joiners should be inserted about halfway into housing. Secure in place by tightening M3 setscrews, using 1.5mm Hex alloy wrench.

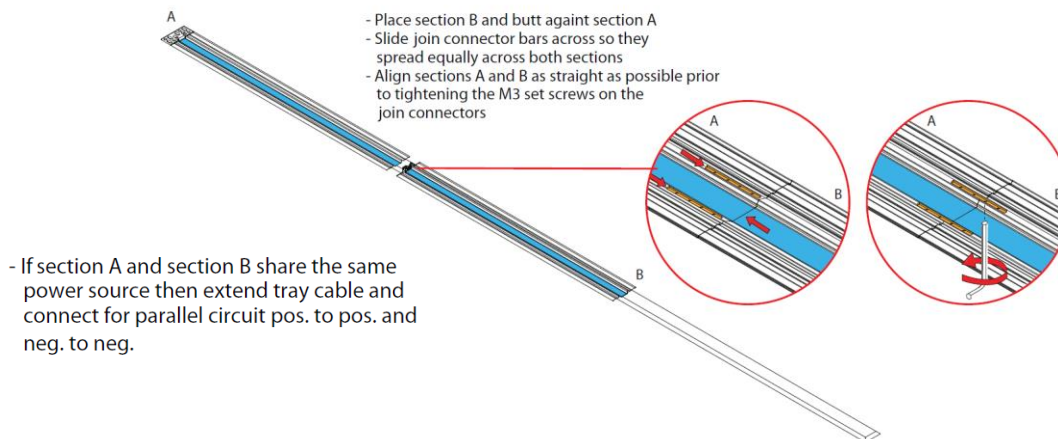

Step 6: Secure luminaire section B to plaster board. Continue step 3 to 6 until reaching the end of the linear run where the last P20LDL housing section is installed which includes the end cap (assembled in Step 1).

Step 7: Secure end piece to plaster board, using #6 drywall screws (supplied by others)

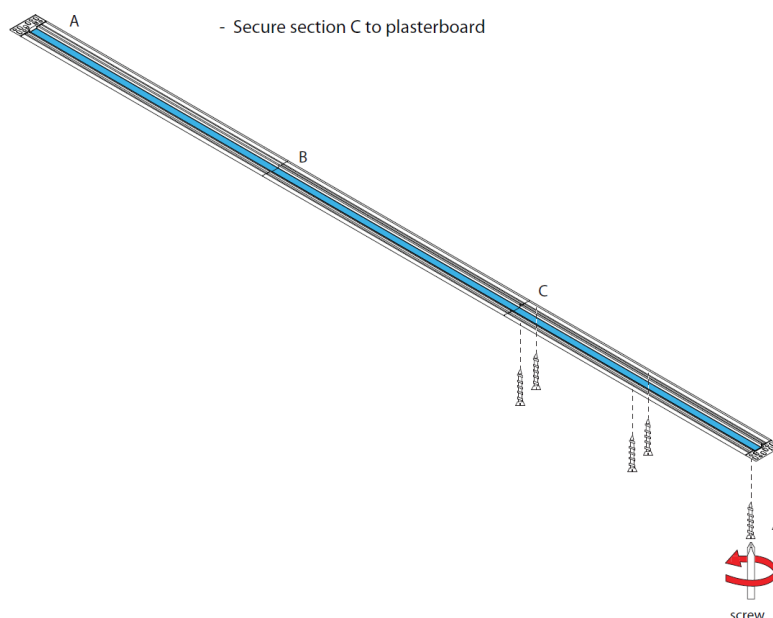

P20LDL – Plaster-in 20 Linear Downlight

Installation Instructions

Page 8

Step 8: Apply plaster so it's even with lens of P20LDL luminaire.

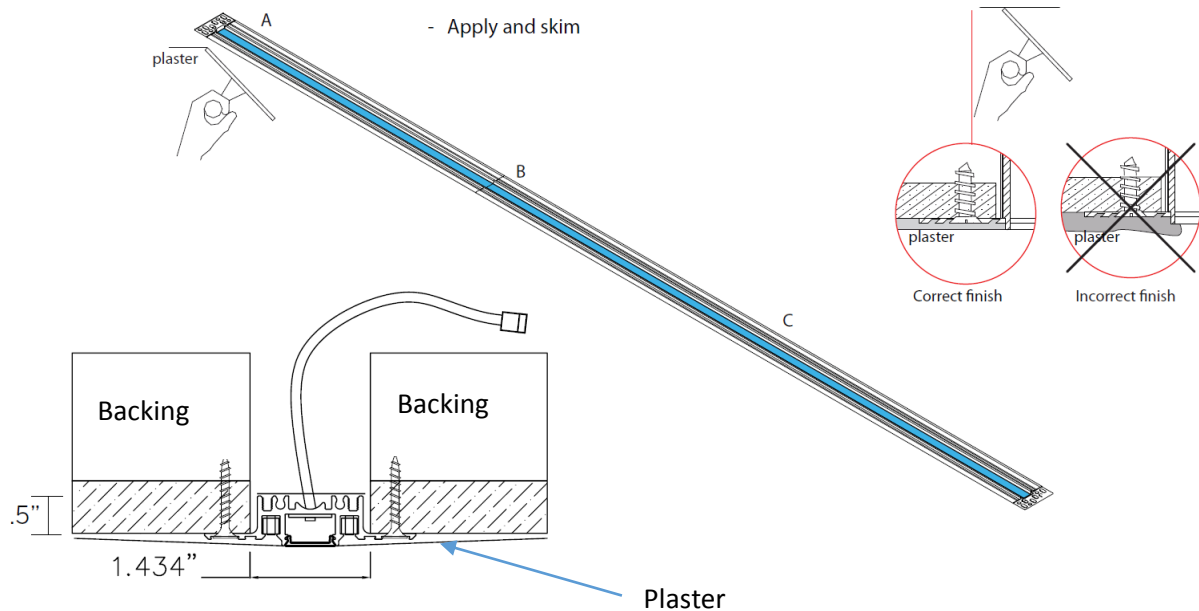

Step 9: Replace sacrificial diffuser with clean finished diffuser after plaster is complete and paint is fully dry.

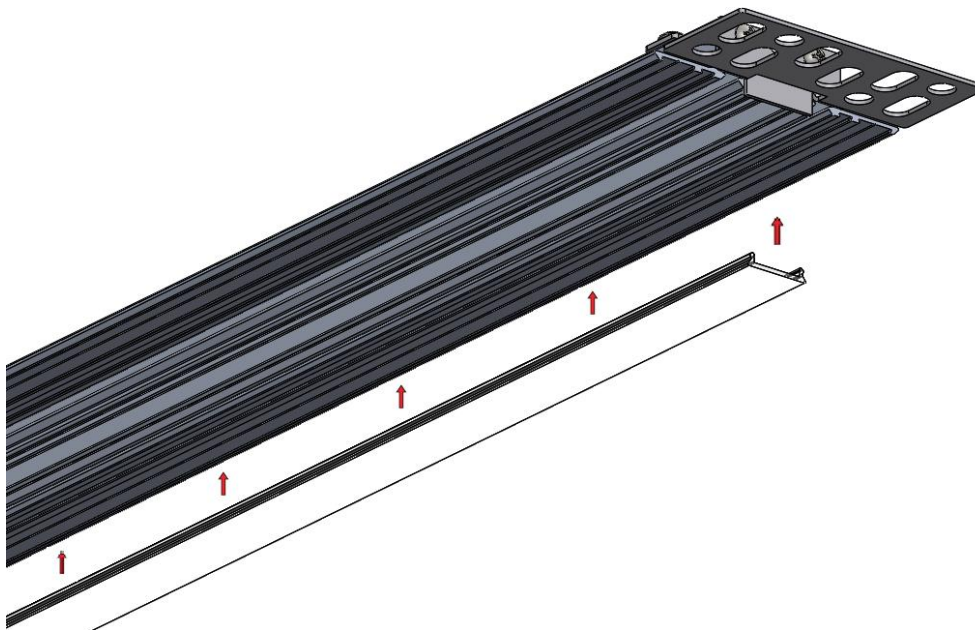

Step 10: Energize and test for proper operation.

Technical Support Line (410) 381-1497

3741 Commerce Drive Suites 306-308 Baltimore, MD 21227 P 410 381 1497 F 410 381 1589
quotes@inter-lux.com orders@inter-lux.com www.inter-lux.com

940-10007 Rev. A