

Iris 67 Zoom Optics



General: Iris 67 is a family of outdoor flood lights that provides one of the most flexible landscape lighting solutions for trees, bushes, sculptures and building facades. Iris 67's main feature is the Zoom optics it comes equipped with, on every size. A Zoom Symmetric option allows to modify the beam spread at any time (15° to 45°), while an even more advanced Zoom Elliptical solution adds to the beam spread adjustability an outstanding beam shaping one, making it the most versatile lighting solution within the same fixture. Lastly, an IP67 rating for temporary submersion makes this flood light unique in its category.

Fixture Body: Open-pore Anodized and Powder Coated Die-Cast Aluminum.

Glass: Extra-clear Tempered glass.

Bracket: 316L Stainless Steel Bracket. Bracket pivots up to 270° on the vertical plane (no horizontal plane adjustment).

Mounting details: Fixture can be installed straight onto surfaces or by using mounting pegs available within the family.

Dimensions/Weight: 1.6" (0.46 lbs) – 2.4" (1.54 lbs) – 3.2" (2.65 lbs) – 3.9" (4.41 lbs)

Driver: Remote, 120-277V Dimmable 0-10V.

Wattages: 6W (1.6") – 13W (2.4") – 20W (3.2") – 30W (3.9")

Cable: Fixture comes with 3.28' of power cable and it's equipped with Acquastop safety system to prevent water and moisture from entering through the cable.

IP rating: IP67 for protection against dust and temporary submersion in water (up to 3' for as long as 30 minutes).

IK rating: IK 10

ETL Certification: ETL, wet location

Optics: Zoom Symmetric (beam spread adjustability) and Zoom Elliptical (beam shaping). Refer to Beam Spread/Shape Chart on this page for exact beam values.

Color temperatures: 2700K – 3000K – 4000K.

CRI: 80+

Lumen Maintenance: L70 projections tested at Tj 65° C and Ta 25°.

Warranty: 5-year Limited Warranty on fixtures. 1-year Limited Warranty on Remote Drivers.



1.6" (6W) ZS

2.4" (13W) ZE



3.2" (20W) ZS

3.9" (30W) ZE

Delivered Lumens [*]	1.6"	2.4"	3.2"	3.9"
ZS @ Max Angle	243	676	1362	2147
ZS @ Min Angle	138	343	818	1439
ZE @ Max Angle	123	594	884	1302
ZE @ Min Angle	78	318	595	1001

^{*}Values shown for 3000K

Beam Spread/Shape	1.6"	2.4"	3.2"	3.9"
ZS	15°-45°	15°-62°	16°-52°	15°-56°
ZE (Max)	46° x 39°	42° x 27°	44° x 36°	46° x 39°
ZE (Min)	40° x 14°	39° x 14°	40° x 16°	40° x 14°

Ordering Information

Product	Trim/Finish	Type	Size	Wattage/Operation	Color Temp	Optic	+	Steel Pegs ¹	Driver (Required) ¹
IR67 = Iris 67	RWH = Round White RBL = Round Black RGR = Round Gray	Z = Zoom optics	16 = 1.6" 24 = 2.4" 32 = 3.2" 39 = 3.9"	6 CC = 6W / Constant Current (630mA) 13 CC = 13W / Constant Current (350mA) 20 CC = 20W / Constant Current (580mA) 30 CC = 30W / Constant Current (840mA)	27 = 2700K 30 = 3000K 40 = 4000K	ZS = Zoom Symmetric ZE = Zoom Elliptical		E84890 (9.84") E98112 (27.56")	ECO30W-XXX SOL050W-XXX SOL0100W-XXX

¹ See page 2

Iris 67 Zoom Optics

ZOOM SYMMETRIC

1.6" 6W 630mA

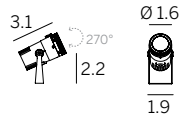

DRIVER OPTIONS (pick one)

C.C. Power supply options (remote only)

ECO30W-630

0-10V EldoLED
ECOdrive 30W
for 1-3 fixtures

SOLO50W-630

0-10V EldoLED
SOLOdrive 50W
for 1-6 fixtures

SOLO100W-630

0-10V EldoLED
SOLOdrive 100W
for 1-12 fixtures

2.4" 13W 350mA

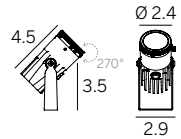

DRIVER OPTIONS (pick one)

C.C. Power supply options (remote only)

ECO30W-350

0-10V EldoLED
ECOdrive 30W
for 1 fixture

SOLO50W-350

0-10V EldoLED
SOLOdrive 50W
for 1-2 fixtures

SOLO100W-350

0-10V EldoLED
SOLOdrive 100W
for 1-4 fixtures

3.2" 20W 580mA

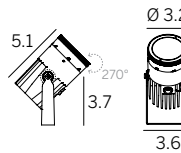

DRIVER OPTIONS (pick one)

C.C. Power supply options (remote only)

ECO30W-580

0-10V EldoLED
ECOdrive 30W
for 1 fixture

SOLO50W-580

0-10V EldoLED
SOLOdrive 50W
for 1-2 fixtures

SOLO100W-580

0-10V EldoLED
SOLOdrive 100W
for 1-4 fixtures

3.9" 30W 840mA

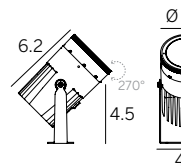

DRIVER OPTIONS (pick one)

SOLO50W-840

0-10V EldoLED
SOLOdrive 50W
for 1 fixture

SOLO100W-840

0-10V EldoLED
SOLOdrive 100W
for 1-2 fixtures

C.C. Power supply options (remote only)

Steel Pegs



E84890
9.84" Steel Peg



E98112
27.56" Steel Peg

Iris 67 Zoom Optics

ZOOM ELLIPTICAL

1.6" 6W 630mA

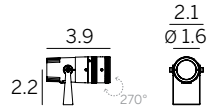

DRIVER OPTIONS (pick one)

C.C. Power supply options (remote only)

ECO30W-630

0-10V EldoLED
ECOdrive 30W
for 1-3 fixtures

SOLO50W-630

0-10V EldoLED
SOLOdrive 50W
for 1-6 fixtures

SOLO100W-630

0-10V EldoLED
SOLOdrive 100W
for 1-12 fixtures

2.4" 13W 350mA

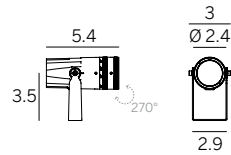

DRIVER OPTIONS (pick one)

C.C. Power supply options (remote only)

ECO30W-350

0-10V EldoLED
ECOdrive 30W
for 1 fixture

SOLO50W-350

0-10V EldoLED
SOLOdrive 50W
for 1-2 fixtures

SOLO100W-350

0-10V EldoLED
SOLOdrive 100W
for 1-4 fixtures

3.2" 20W 580mA

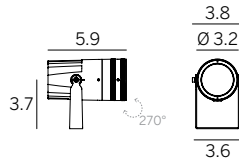

DRIVER OPTIONS (pick one)

C.C. Power supply options (remote only)

ECO30W-580

0-10V EldoLED
ECOdrive 30W
for 1 fixture

SOLO50W-580

0-10V EldoLED
SOLOdrive 50W
for 1-2 fixtures

SOLO100W-580

0-10V EldoLED
SOLOdrive 100W
for 1-4 fixtures

3.9" 30W 840mA

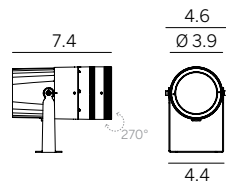

DRIVER OPTIONS (pick one)

SOLO50W-840

0-10V EldoLED
SOLOdrive 50W
for 1 fixture

SOLO100W-840

0-10V EldoLED
SOLOdrive 100W
for 1-2 fixtures

C.C. Power supply options (remote only)

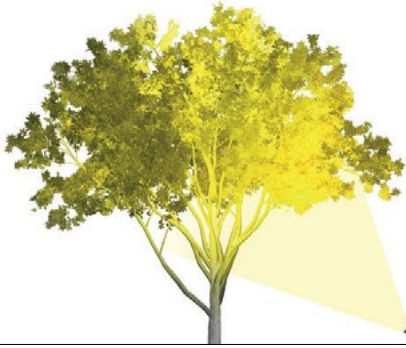

IRIS 67 ZOOM SYMMETRIC

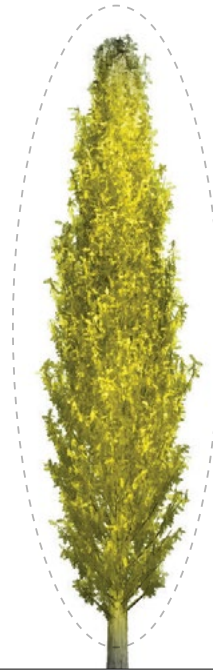
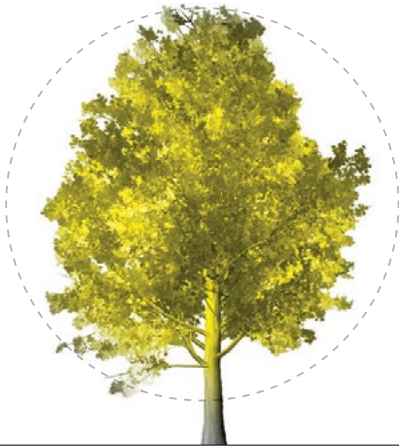

IRIS 67 ZOOM ELLIPTICAL