

4" ProTools Downlight (Shallow) Round Recessed

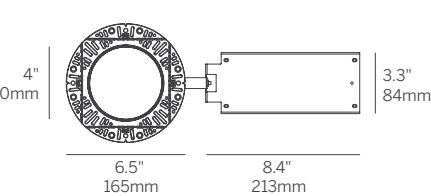

4" round aperture downlight for wide distribution general illumination. Available with round recessed cone or regressed pinhole with 0.5" regressed 2" round light aperture or high transmission, evenly illuminated flush full aperture diffuser.

Housing	Die-caste aluminum for precision fit and heat dissipation Mounting hardware for all ceiling types; trim and trimless EZ clip mounting for secure installation Trimless housing with Multiple Luminaire Configurations feature allows endless multiple combinations without specialized housings
Covers	RFD - Round Flush Diffuser for high angle diffuse illumination RRC - Round Recessed Cone for low brightness, general illumination RRP - Round Regressed Pinhole offers the smallest aperture and maximum glare control
LED	Constant Current Control, 92+ CRI, 3-Step MacAdam Low/Mid/High output choices (delivers up to 77 lumens per watt) 2700K, 3000K, 3500K, 4000 L70 (TM21 Projected 85° C) Static White = 102,000 hours
Beam	Lambertian or 110° beam spread
Driver	Integral drivers for all dimming and non-dimming applications Non-Dim, 0-10V, Phase, Lutron and DALI driver options Through-wire integral driver enclosure installed from below without the need for bulky housing POE driver compatibility
Installation Housing	Not required when using the Driver Enclosure LP - Landing Pan NC - New Construction IC - Insulated Ceiling CP - Chicago Plenum
Warranty	5-year Limited (see complete company warranty information)
Certifications	ETL and ETL-C for dry and damp location, (WL Wet Location optional), CE



RPT / FRD

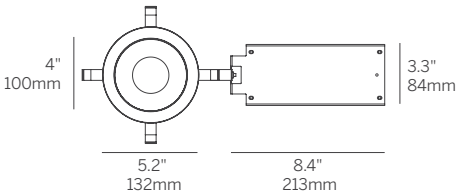

RBT / RRC

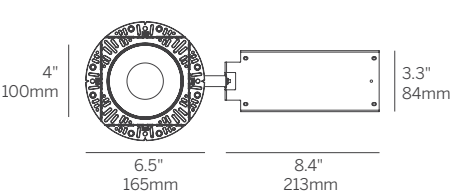

RPT / RRP



RPT / RFD / SOD



RBT / RRC / RSC



RPT / RRP / RSC

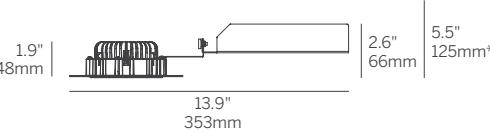

4" ProTools Downlight (Shallow) Round Recessed

Model	Fixation	Power <sup>1</sup>	CRI	CCT <sup>2</sup>	Driver <sup>3</sup>	Cover	Lens	Beam	Trim Finish	Cover Finish	Housing <sup>4</sup>	Options
WG-100RPTD	RPT RBT	L M H	92	27 30 35 40	S010 D010 SPH PEQ0 D2S	RFD	SOD	LAM	W B S F	W B S F	LP NC IC CP X	WL TC MLC EM
						RRC RRP	RSC	110				

Model

- WG-100RPTD = 4" ProTools Downlight (Shallow) Round Recessed

Fixation

- RPT = Recessed Plaster Trim
- RBT = Recessed Bezel Trim

Power<sup>1</sup>

- L = Low Power, 11W @ 350mA
- M = Mid Power, 15W @ 500mA
- H = High Power, 22.5W @ 700mA

CRI

- 92 = 92+ CRI

CCT<sup>2</sup>

- 27 = 2700K
- 30 = 3000K
- 35 = 3500K
- 40 = 4000K

Driver<sup>3</sup>

- S010 = eldoLED 0-10V 1% dimming, 120-277V (30W)
- D010 = eldoLED 0-10V 0.1% dimming, 120-277V (30W)
- SPH = Phase (2-wire) 3% dimming, 120V only (20W)
- PEQ0 = Lutron Hi-Lume Premier 0.1% EcoSystem dimming, 120-277V (20W) [N/A for High Power]
- D2S = DALI-2 (DT6) for Static White 0.1% dimming, 120-277V (30W)

Cover

- RFD = Round Flush Diffuser
- RRC = Round Recessed Cone
- RRP = Round Regressed Pinhole

Lens

- SOD = Satin Opal Diffuser
- RSC = Recessed Satin Clear Lens

Beam

- LAM = Lambertian
- 110 = 110° Beam Angle

Trim / Cover Finish (N/A for SFD)

- W = White, 15% gloss, RAL 9003 (standard)
- B = Black, 15% gloss, RAL 9005
- S = Silver, 15% gloss, RAL 9006
- F = Custom finish, specify RAL code

Housing (optional)<sup>4</sup>

- LP = Landing Pan
- NC = New Construction Housing
- IC = Insulated Ceiling Housing
- CP = Chicago Plenum Housing
- X = No Housing

Options

- WL = Wet Location (RRC only)
- TC = Thick Ceiling Clip (see detail page)
- MLC = Multiple luminaire configurations (see detail page)
- EM = Emergency (remote only)

Whitegoods reserves the right to change any information without prior notice.

Notes

- Wattage shown does not include power supplies/drivers.
- See photometric data sheet for delivered lumens.
- See driver information for details.
- See housings pages for details.