

4" Square Ceiling / Floor Wash



4" square aperture recessed wall fixture with concealed source providing asymmetric illumination for ceiling or floor wash applications.

Housing	Die-caste aluminum for precision fit and heat dissipation 3/8" bezel trim compatible with installation into walls Luminaire installed and maintained from the wall side. Maximum wall thickness 5/8" (4.5" minimum clearance in wall). Spring clip mounting mechanism EZ-Click LED module installation
LED	Constant Current, 92+ CRI (standard), 2-Step MacAdam Low/Mid/High output choices (delivers up to 63 lumens per watt) 2700K, 3000K, 3500K, 4000K L70 (TM21 Projected 85°C) Static White = 55,400 hours
Optics	High angle asymmetrical distribution
Driver	Remote drivers for all dimming and non-dimming applications 0-10V, Phase, Lutron, and DALI driver options
Warranty	5-year Limited (see complete company warranty information)
Certifications	ETL and ETL-C for dry and damp location, CE

cut-out dimensions 4 5/8" x 4 5/8"



Recessed Plaster Trim



Recessed Bezel Trim

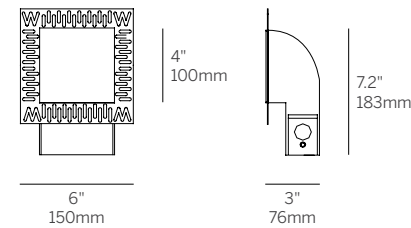

Recessed Plaster Trim (RPT)

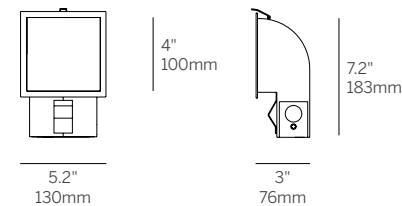

Recessed Bezel Trim (RBT)

4" Square Ceiling / Floor Wash

Model	Fixation	Power ¹	CRI	CCT ²	Driver ³	Finish	Options
WG-100SCFW	RPT RBT	L M H	92	27 30 35 40	RS010 RD010 RSPH RPEQ0 RD2S X	W	EM AWNRF

Model

- WG-100SCFW = 4" Square Ceiling / Floor Wash

Fixation

- RPT = Recessed plaster trim
- RBT = Recessed bezel trim

Power¹

- L = Low power, 8.1W @ 250mA
- M = Mid power, 11.5W @ 350mA
- H = High power, 16.8W @ 500mA

CRI

- 92 = 92 CRI

CCT²

- 27 = 2700K
- 30 = 3000K
- 35 = 3500K
- 40 = 4000K

Driver (Remote)³

- RS010 = Remote eldoLED 0-10V 1% dimming, 120-277V (22W, 50W, 100W)
- RD010 = Remote eldoLED 0-10V 0.1% dimming, 120-277V (22W, 50W or 100W)
- RSPH = Remote phase (2-wire) 3% dimming, 120V only (20W)
- RPEQ0 = Remote Lutron Hi-Lume Premier 0.1% EcoSystem dimming, 120-277V (20W)
- RD2S = Remote DALI-2 for Static White 0.1% dimming, 120-277V (22W, 50W or 100W)
- X = No Driver

Finish

- W = White, 15% gloss, RAL 9003

Options

- EM = Emergency (remote)
- AWNRF = Lutron Athena Wireless Node RF (RS010, RD010, RD2S drivers only)

Whitegoods reserves the right to change any information without prior notice.

Notes

- Wattage shown does not include power supplies/drivers.
- See photometric data sheet for delivered lumens.
- Refer to power supply page for details.