

Ordering Information

| Model | Fixation | Pattern | Length | Power ³ | CRI/CCT ⁴ | Driver ⁵ | Lens | Finish | Options |
|-------|----------|--|--|--------------------|--------------------------|---|------|------------------------|---------|
| WG-WC | SM | S ¹ PC ² PR ² | A A x B A x B x C A x B x A x B | L M | 927 930 935 940 | X S D010 DPH L3DAE L3D0E EL96 | SDC | W (std) B S F | EM |

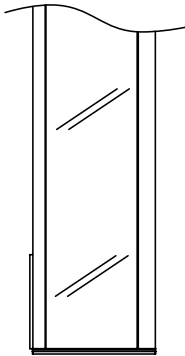

3.6" (91mm)

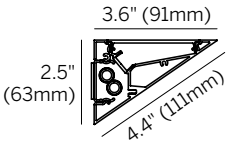

2.5" (63mm)

3.6" (91mm)

4.4" (111mm)

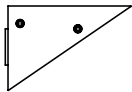

End Cap (2 included)

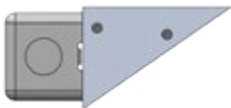

Mounts to 4" J-box (by others)

Luminaire

- Continuous surface wall, ceiling or mullion mounted cove system that delivers an even wash of directed light to the ceiling above, and redirected light to softly illuminate the wall behind the fixture.
- Light source positioned for optimum vertical spread of illumination.
- Extruded aluminum housing (powdercoat painted), easily installed internal LED tray assembly. Remote driver. Field replaceable LED boards.
- Satin clear diffuser for high efficiency and soft edge beam without striations. Efficacy up to 99 lumens per watt (delivered).
- 90+ CRI, 3 Step MacAdam.
- L70 (TM21 Projected 85C) Static White 60,000 hours.
- ETL and ETL-C for dry and damp locations.

Fixation

- SM = Surface Mount to wall, ceiling or mullion

Pattern

- S = Straight run¹
- PC = Standard patterns coffer 2, 3 or 4 sided with 90° inside corners²
- PR = Standard patterns raft 2, 3 or 4 sided with 90° outside corners²

Length

- A, B, C = specify inches to the nearest 0.25" (i.e. 72.25") For patterns specify each length (i.e. 2 sided: A x B = 72.25" x 48"; 3 sided: A x B x C; 4 sided: A x B x A x B)

Power³

- L = 3W/ft low power (24V)
- M = 6W/ft mid power (24V)

CRI/CCT (90+ CRI)⁴

- 927 = 2700K
- 930 = 3000K
- 935 = 3500K
- 940 = 4000K

Driver (remote)⁵

- X = No driver, ordered separately
- S = Standard, non-dim driver 120-277V
- D010 = Osram, 10%, 0-10V dimming, 120-277V
- DPH = Phase Dimming, 1% dimming, 120V only
- L3DAE = Lutron Hi-lume 1% EcoSystem, 120-277V
- L3D0E = Lutron Hi-lume Premier 0.1% EcoSystem, 120-277V
- EL96 = Osram / EldoLED, 24V, 0.1% 0-10V Dimming

Lens

- SDC = Satin dust cover (standard)

Finish

- W = White, 15% gloss, RAL 9003 (standard)
- B = Black, 15% gloss, RAL 9005
- S = Silver, 15% gloss, RAL 9006
- F = Custom finish, specify RAL code

Options

- EM = Emergency LED driver (remote)

- 1 Standard setup assumes the cove ends at a perpendicular wall and the LED board is setback from the end to minimize light on the perpendicular wall. Contact us for options.
- 2 See pattern specsheet.
- 3 Wattage shown does not include power supplies/drivers.
- 4 See photometric data sheet for delivered lumens.
- 5 See power supply page for details.

PATTERN COFFER (PC)

WG-WC-SM-PC-...

PATTERN RAFT (PR)

WG-WC-SM-PR-...

