

## Ordering Information

Model	Fixation	Pattern	Length	Power <sup>1</sup>	CRI/CCT <sup>2</sup>	Driver <sup>3</sup>	Lens	Finish	Options
WG-WCWL	SM	S	24 36 48 60 XX	XL L M	927 930 935 940	X S D010 DPH L3DAE L3D0E EL96	SDC	W (std) B S F	EM

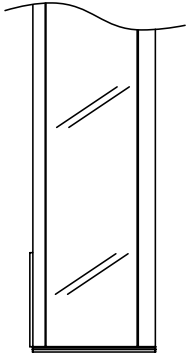

3.6" (91mm)

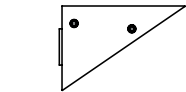
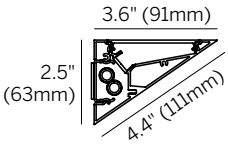

End Cap (2 included)

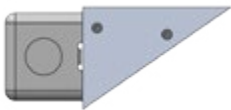

Mounts to 4" J-box (by others)

### Luminaire

- Continuous surface wall, ceiling or mullion mounted cove system that delivers an even wash of directed light to the ceiling above, and redirected light to softly illuminate the wall behind the fixture.
- Light source positioned for optimum vertical spread of illumination.
- Extruded aluminum housing (powdercoat painted), easily installed internal LED tray assembly. Remote driver. Field replaceable LED boards.
- Satin clear diffuser for high efficiency and soft edge beam without striations. Efficacy up to 82 lumens per watt (delivered).
- 90+ CRI, 3 Step MacAdam.
- L70 (TM21 Projected 85C) Static White 60,000 hours.
- ETL and ETL-C for dry, damp or wet locations.

### Fixation

- SM = Surface Mount to wall, ceiling or mullion

### Pattern

- S = Straight run

### Length

- 24 = 24.0" (609.6mm)
- 36 = 36.0" (914.4mm)
- 48 = 48.0" (1219.2mm)
- 60 = 60.0" (1524mm)
- XX = Specify inches to the nearest 0.25 (i.e. 72.25")  
Max 1 piece 96" - nonstandard

### Power<sup>1</sup>

- XL = 1.4 W/ft extra low power (24V)
- L = 3.0 W/ft low power (24V)
- M = 4.4 W/ft mid power (24V)

### CRI/CCT (90+ CRI)<sup>2</sup>

- 927 = 2700K
- 930 = 3000K
- 935 = 3500K
- 940 = 4000K

### Driver (remote)<sup>3</sup>

- X = No driver, ordered separately
- S = Standard, non-dim driver 120-277V
- D010 = Osram, 10%, 0-10V dimming, 120-277V
- DPH = Phase Dimming, 1% dimming, 120V only
- L3DAE = Lutron Hi-lume 1% EcoSystem, 120-277V
- L3D0E = Lutron Hi-lume Premier 0.1% EcoSystem, 120-277V
- EL96 = Osram / EldoLED, 24V, 0.1% 0-10V Dimming

### Lens

- SDC = Satin dust cover (standard)

### Finish

- W = White, 15% gloss, RAL 9003 (standard)
- B = Black, 15% gloss, RAL 9005
- S = Silver, 15% gloss, RAL 9006
- F = Custom finish, specify RAL code

### Options

- EM = Emergency LED driver (remote)

<sup>1</sup> Wattage shown does not include power supplies/drivers.

<sup>2</sup> See photometric data sheet for delivered lumens.

<sup>3</sup> See power supply page for details.